

BOX CONTENT

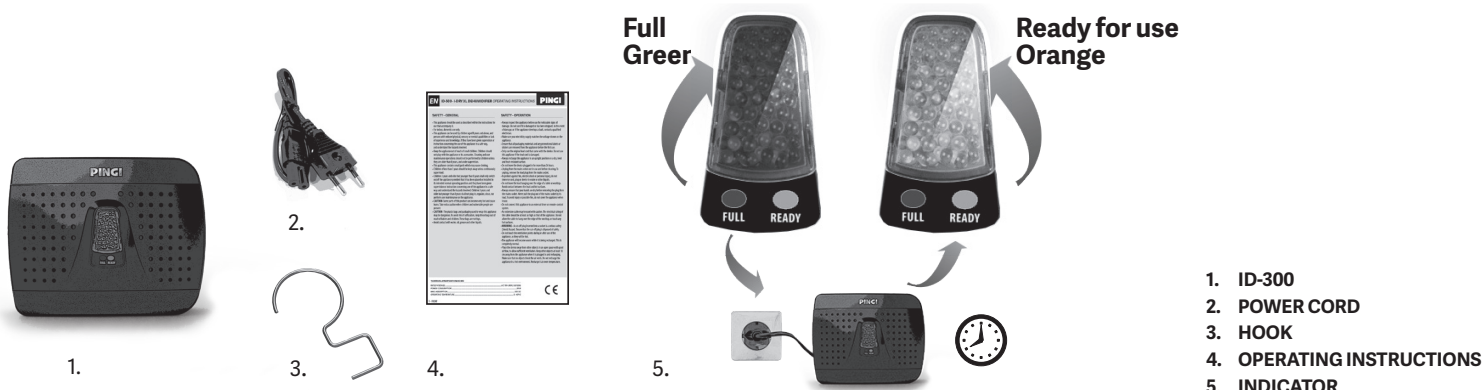

1. ID-300
2. POWER CORD
3. HOOK
4. OPERATING INSTRUCTIONS
5. INDICATOR

INTENDED USE

The ID-300 is suitable for dehumidifying enclosed indoor spaces. The appliance is powered by the power cord/lead cord that is supplied with the device. The device operates on 100-240V, 50/60Hz (mains electricity). Never try to connect the device to other power sources. Please always follow the safety instructions in this manual. Keep this instruction manual in a safe place, so that it is available at all times. This product complies with regulatory, national and European requirements. Never try to make technical modifications to this device. We do not accept liability for accidents or damages resulting from failure to follow these operating and safety instructions.

FUNCTION AND APPLICATION

The ID-300 was developed as a rechargeable dehumidifier that gradually absorbs excess moisture in small, enclosed spaces. This product is ideally suited for small unventilated spaces like closets, storage boxes and cellars. It is also great for use in caravans and boats. When not plugged in, the device collects moisture from its surroundings. When the ID-300 is approx. 80% full, the indicator-pearls will change colour from orange to green. You can then use the power cable to connect it to mains electricity. During recharging your ID-300 will hygienically release the absorbed moisture by evaporating it. That is why it is important to only recharge the appliance in a well ventilated-space, where the evaporated moisture is harmless (eg. the kitchen). The appliance never needs refilling.

INSTALLATION

Please carefully read the safety instructions on the front page of this manual before getting started. Please remove the plastic wrapping from the product before first use. Are the indicator-pearls green? The ID-300 is saturated with moisture. First connect the device to mains electricity for 15-20 hours. Do this in a well ventilated area. Are the indicator-pearls orange? You can start using the ID-300 right away. You only need to recharge the appliance when the indicator-pearls are clearly green.

OPERATION

Ready for use: The indicator-pearls should be orange. This means sufficient moisture absorption capacity is available. Your ID-300 is ready for use. It can now be deployed. Do not plug in the power cord; the ID-300 absorbs moisture without using electricity.

Saturated: During use, the indicator-pearls change colour from orange to green. This means that the device is full of moisture and can be recharged.

Recharging: To recharge ID-300, connect the power cable to the socket on the back of the device and insert the plug into the power point. Recharge the appliance in an upright position. Recharging begins automatically when the ID-300 is connected to the mains electricity. While recharging, the moisture absorbed by the device is gradually released. After 15 to 20 hours of recharging, the indicator-pearls will again turn orange. You can now unplug the appliance from the power point and remove the power cord. Your ID-300 is ready for use again. Recharging works best in a well-ventilated area indoors and can be repeated time and time again.

Hanging: The included metal hook can be used to hang the device between your clothes in your wardrobe. Press the straight part of the hook into the round hole on the back of the device.

DISPOSAL OF THE DEVICE



Do not dispose of electrical appliances as unsorted municipal waste, use separate collection facilities. Contact your local government for information regarding the collection systems available. If electrical appliances are disposed of in landfills or dumps, hazardous substances can leak into the groundwater and get into the food chain, damaging your health and well-being. When replacing old appliances with new ones, the retailer is legally obligated to take back your old appliance for disposal at least for free of charge.

CLEANING

If necessary, wipe off the exterior of the ID-300 with a lightly dampened cloth. While recharging, the device automatically kills bacteria, etc. absorbed in the water.

LIMITED 5-YEAR WARRANTY

InnoGoods BV guarantees your appliance (ID-300) against material and fabrication faults for 5 years after initial purchase. Should material or fabrication faults be found, InnoGoods will repair or replace the device with a similar or better-specified product. Damage to the device due to any form of negligence, accident, lack of cleaning and maintenance, or other use or abuse that can reasonably be considered to be in conflict with the directions described in these instructions, does not fall under this warranty. Furthermore, legal provisions with respect to consumer purchases apply. In the event of a fault, we advise you to return the product together with the original proof of purchase to the store where you bought it. When the defect in the device is caused by anything other than material or fabrication faults, you may be charged for examination and repair costs.

TROUBLESHOOTING

How do I switch on the device?

This device does not have an ON/OFF switch. Your ID-300 continuously absorbs moisture, unless it is connected to mains electricity for recharging.

The device does not seem to be absorbing any moisture.

- Check the relative humidity in the surrounding space.
- Check the indicator colour. Does the ID-300 need recharging?
- Are the ventilation openings in the body blocked?
- Connect the device to mains electricity for 20 hours and check its weight. Wait for 7 days and weigh again. Do you notice a weight increase?

My ID-300 does not seem to have very much effect yet.

- Is there a large source of humidity in the space that produces large amounts of water?
- Is the device being used in an unventilated area?
- The device was designed to gradually absorb moisture. Has sufficient time passed? Sometimes multiple cycles are needed to remove moisture already present in the enclosed space.

I think it is saturated, but I do not see any green light.

The indicator does not need LED-lights. Carefully check the colour of the indicator-pearls.

The device feels very warm and/or there is a small puddle of water beneath the device.

It is normal for the device to get warm during recharging. It is also possible for some water to condense beneath your ID-300 during recharging. Moisture will never leak during use. Make sure not to recharge the device on moisture- or heat-sensitive surfaces.

The indicator-pearls are not green, but are also not orange either.

This is an intermediate colour. You can keep using the device until the indicator-pearls become green.

CONTACT/SERVICE:

InnoGoods BV	Rivium 2e str. 40	www.pingi.com
PO Box 81180	NL-2909 LG Capelle	
NL-3009 GD	a/d IJssel	
Rotterdam	+49 20 514 051790	
The Netherlands	+31 88 995 1000	

SAFETY – GENERAL

- This appliance should be used as described within the instructions for use that accompany it.
- For indoor, domestic use only.
- This appliance can be used by children aged 8 years and above, and persons with reduced physical, sensory or mental capabilities or lack of experience and knowledge, if they have been given supervision or instruction concerning the use of the appliance in a safe way, and understand the hazards involved.
- Keep the appliance out of reach of small children. Children should not play with the appliance or its accessories. Cleaning and user maintenance operations should not be performed by children unless they are older than 8 years, and under supervision.
- This appliance contains small parts which may cause choking.
- Children of less than 3 years should be kept away unless continuously supervised .
- **CAUTION**-Some parts of this product can become hot. Take extra caution when children and vulnerable people are present.
- **CAUTION**- The plastic bags and packaging used to wrap this appliance may be dangerous. To avoid risk of suffocation, keep these bags out of reach of babies and children. These bags are not toys.
- Avoid contact with water, oil, grease and other liquids.

SAFETY – OPERATION

- Always inspect the appliance before use for noticeable signs of damage. Do not use if it is damaged or has been dropped. In the event of damage, or if the appliance develops a fault, contact a qualified electrician.
- Make sure your electricity supply matches the voltage shown on the appliance.
- Ensure that all packaging materials and any promotional labels or stickers are removed from the appliance before the first use.
- Only use the original lead cord that came with the device. Do not use this appliance if the lead cord is damaged.
- Always recharge the appliance in an upright position on a dry, level and heat-resistant surface.
- Do not leave the device plugged in for more than 24 hours.
- Unplug from the mains when not in use and before cleaning. To unplug, remove the lead plug from the mains socket.
- To protect against fire, electric shock or personal injury, do not immerse cord, plug or device in water or other liquids.
- Do not leave the lead hanging over the edge of a table or worktop. Avoid contact between the lead and hot surfaces.
- Always ensure that your hands are dry before removing the plug from the mains socket. Never pull the plug out of the mains socket by its lead. To avoid injury or possible fire, do not cover the appliance when in use.
- Do not connect this appliance to an external timer or remote-control system.
- An extension cable may be used with caution. The electrical rating of the cable should be at least as high as that of the appliance. Do not allow the cable to hang over the edge of the worktop, or touch any hot surfaces.
- Do not touch the ventilation points during or after use of the appliance, as they will be hot.
- The appliance will become warm while it is being recharged. This is completely normal.
- Place the device away from other objects in an open space with good airflow, to allow sufficient ventilation. Keep other objects at least 10 cm away from the appliance when it is plugged in and recharging. Make sure that no objects block the air vents. Do not recharge the appliance in a hot environment. Recharge it at room temperature.

TECHNICAL SPECIFICATIONS ID-300

RATED VOLTAGE	AC 100–240V, 50/60Hz
POWER CONSUMPTION.....	22 W
MAX. ABSORPTION.....	120 CC
OPERATING TEMPERATURE.....	5 - 40° C

